



MADE IN TAIWAN

## MSQ-3400D 2CH Audio I/O Adapter

### Introduction

The MSQ-3400D 2CH Audio I/O Adapter allows digital audio to be distributed over an IP network. The MSQ-3400D supports 2 channels, featuring high-quality XLR input and output connectors. Furthermore, the MSQ-3400D can transmit uncompressed, low-latency digital audio signals over a standard IP network. The MSQ-3400D has built-in PoE (Power over Ethernet) and can be powered by any standard PoE network switch.

**Package Contents** • 1x MSQ-3400D • 1x 5V DC USB Wall Charger • 1x User Manual

### Features

- Supports two XLR connectors, input & output for digital AES3 audio\*
- Supports DHCP & static IP configuration
- Supports sample rates up to 96kHz
- Supports PoE (Power over Ethernet)
- Dante audio over IP and AES67 RTP transport formats
- Excellent dynamic range, SNR and THD performance

\*Does NOT work with analog equipment, the XLR connectors are ONLY for the digital AES3 signal.

 [www.maxsquare.com.tw](http://www.maxsquare.com.tw)

 [support@maxsquare.com.tw](mailto:support@maxsquare.com.tw)

**CUSTOMER SERVICE & TECHNICAL SUPPORT**  
[support@maxsquare.com.tw](mailto:support@maxsquare.com.tw)

Maxsquare warrants our products for a one year limited warranty. Thank you for choosing us, we appreciate if you tell us your suggestions and leave us a review on Amazon.

## Specifications

Model Name	MSQ-3400D
Sample rates	44.1, 48, 96kHz
Dante device latency	1, 2, or 5ms (configurable using Dante Controller)
Network transport	Dante Audio over IP, AES67 RTP
ESD protection	Human body model — ±15kV [air-gap discharge] & ±8kV [contact discharge]
PCB stack-up	4-layer board [impedance control — differential 100Ω ; single 50Ω ]
Input / Output	1x XLR (Female) / 1x XLR (Male)
I/O	1x RJ-45
XLR connector	XLR male & female
RJ-45 connector	WE/SS 8P8C with 2 LED indicators

## Panel Descriptions

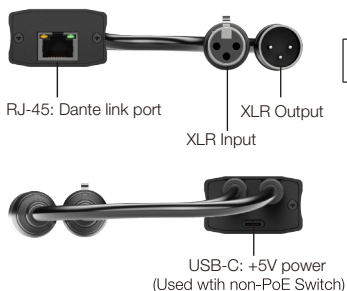

## Connection Diagram

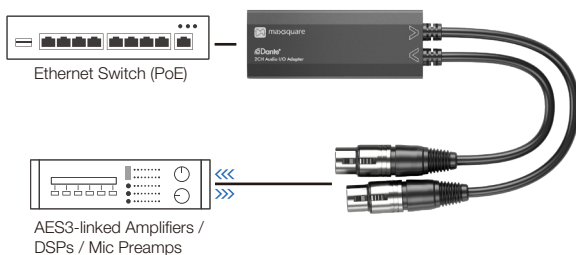

## Dante Controller [User Guide] (<https://www.audinate.com/learning/technical-documentation>)

Dante Controller provides users to configure and route audio around Dante networks. Please use it to make connections between Dante devices on your network.

## Download the software (<https://www.audinate.com/products/software/dante-controller>)

Browse the download page of the Dante Controller website and create an account to download the software.

## Device setup steps

1. Connect the device to Network.
2. Make sure to set up your PC/ Mac and the device in the same domain.
3. Start to use Dante Controller.

## Choose A Network Switch (<https://www.getdante.com/support/faq/networks-and-switches>)

Please refer to the link to choose a Network Switch.

## The selected network switch must support the following:

- Gigabit ports for inter-switch connections
- Quality of Service (QoS) with 4 queues
- Diffserv (DSCP) QoS, with strict priority
- Managed switch for detailed network link information
- IGMP snooping (routing for Dante AV devices)

## Switches incompatible with Dante:

Switches with EEE support may cause poor synchronization and occasional packet loss

**Warranty** | For more warranty information, please check on our official website: <https://maxsquare.com.tw/warranty/> or contact [support@maxsquare.com.tw](mailto:support@maxsquare.com.tw)